

HOUSE & LAND PACKAGE

Lot 23, Pembroke

\$750,500*



Ballarat Premier

BY HUME BUILDING



4



2



2

This impressive country style home is as striking as it is practical. Boasting four separate living areas including; theatre room, family room, lounge room and sun room. There are four bedrooms

each with walk-in robe and ensuite to master. Create your dream lifestyle in this quality assured home.

Home and Land Package Inclusions:

- 4,004m2 homesite, lot 23 Pembroke
- Located only a short stroll away from future village centre and primary school
- Home warranty
- Open-plan living with kitchen overlooking sun room and alfresco area
- Theatre room
- Large veranda
- Huge family room and separate lounge room
- Built-in wardrobes to all bedrooms
- Walk-in wardrobe and ensuite to master
- Double garage with internal access
- Gas cook-top and oven
- Floor coverings
- Site cost allowance
- Gas-fired fire place
- Double garage with undercover access to home
- Large alfresco area adjoining family room
- Gas-boosted solar hot water system

Ballarat Premier

BY HUME BUILDING

Lot 23, Pembroke

\$750,500*

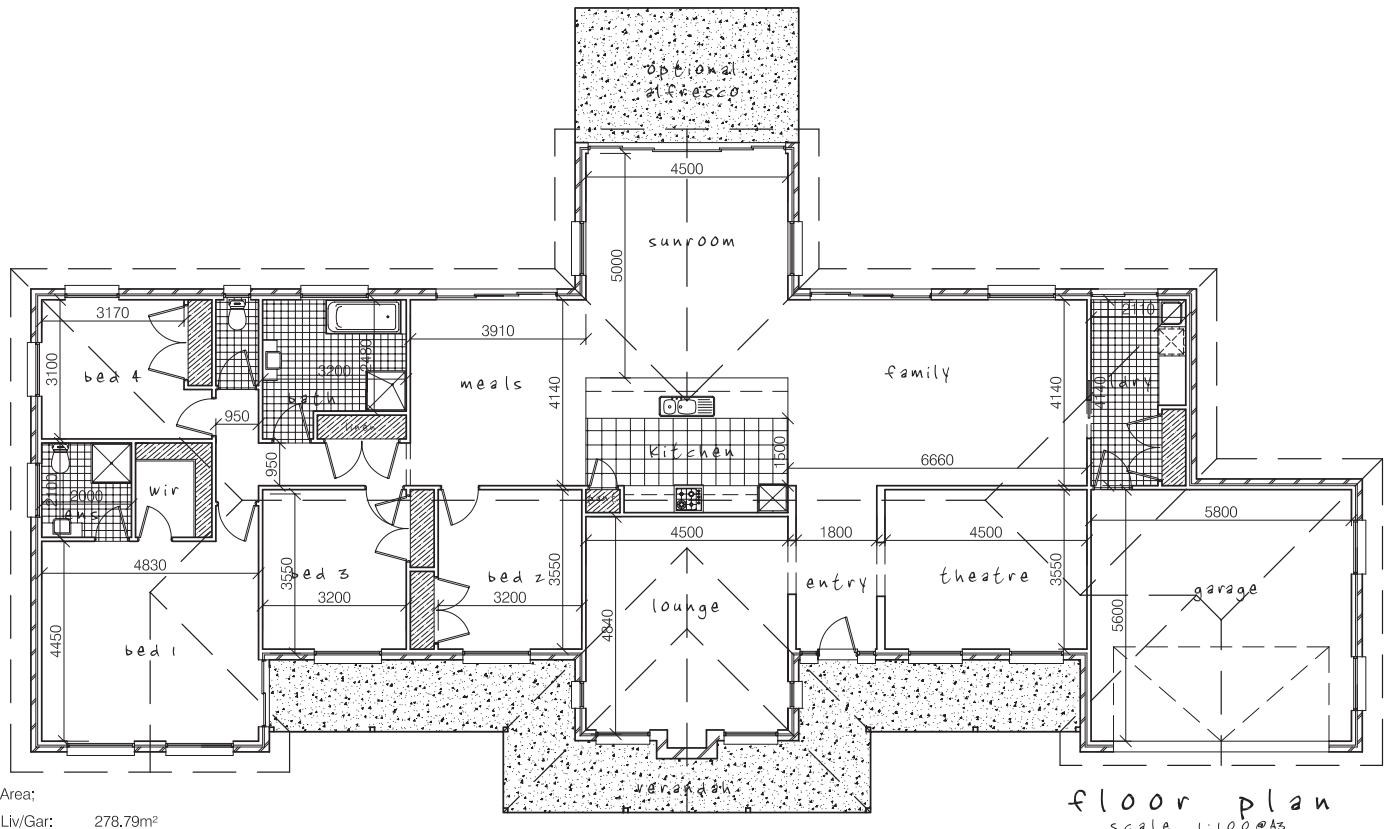

Details:

HOME SIZE:	-
LAND SIZE:	4004 sqm
BEDROOMS:	4
BATHROOMS:	2
GARAGE:	2

* Prices correct as at January 2011. Prices are subject to builder terms and conditions. House prices are subject to change without notice and should be confirmed with the Builders. Artist illustrations depicting exterior facades are meant as a guide only. Some exclusions may apply. For terms and conditions refer Sales and Information Centre and Builder Offices.